

SOUTH LODGE

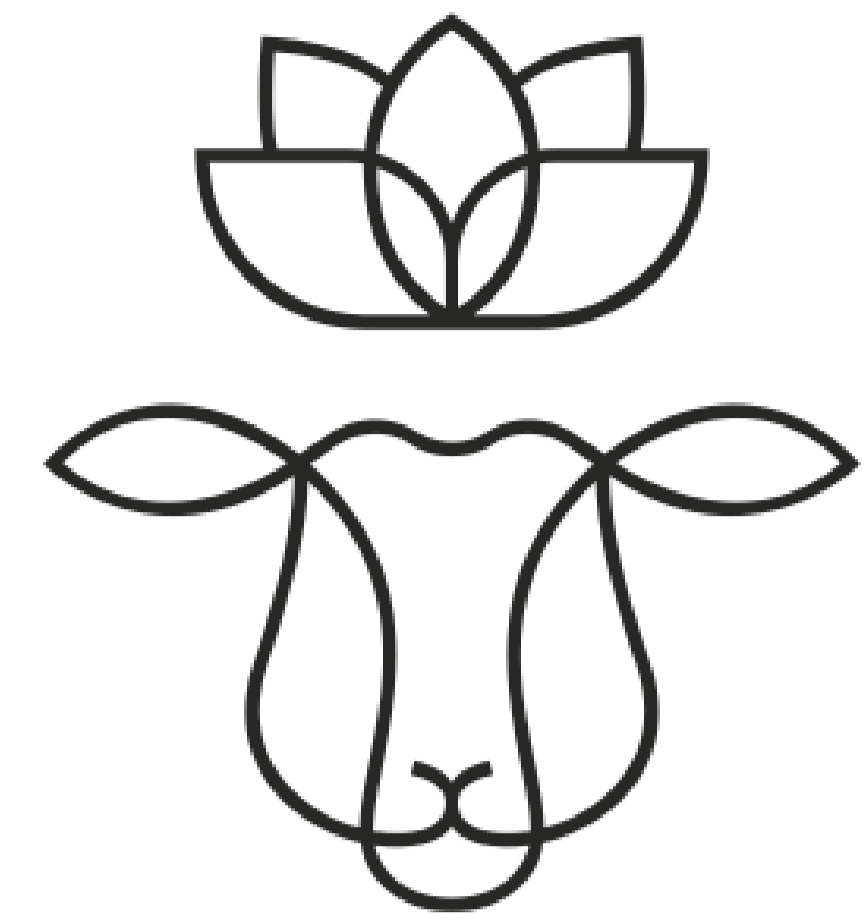

Churchill

Ceiling height

Max 3.95m (13'0")

Min 3.35m (11'0")

Total approximate floor area

71.3 sq mt (767.4 sq ft)

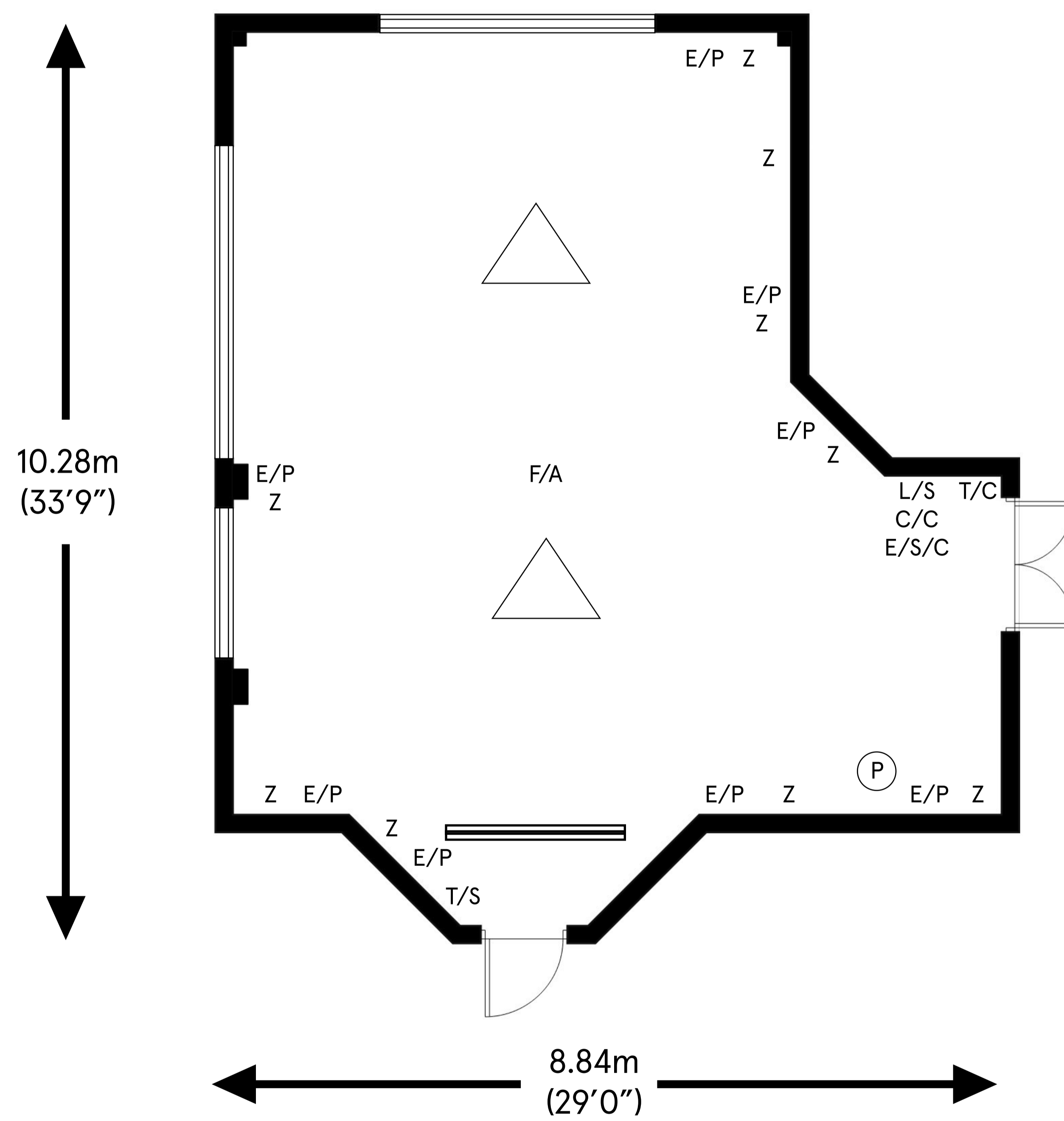

Key:

- | | | | |
|-------|-------------------------|-----|----------------------------|
| Z | 13 Amp Sockets | △ | Chandelier |
| E/P | Ethernet Port | T/C | Temperature Control |
| Ⓟ | Phone Line | T/S | TV Socket |
| L/S | Light switch Panel | ≡ | Drop Down Projector Screen |
| C/C | Curtain Control | | |
| E/S/C | Electric Screen Control | | |
| F/A | Fire Alarm | | |

For room capacity please refer to the room configuration charts